

General
Mixing
Applications



Zero-g

Magnetic Mixer

ZG Mixers are very versatile and are the base line of our mixer program. The high efficiency Mix Head design allows for both effective and gentle mixing at the same time. The ZG Mixer covers a vast range of applications all through the process chain. The excellent aseptic design, FDA compliance, combined with the benefits of the new and innovative bearing design makes it perfect for use in the pharmaceutical and biotechnology industries.

Basic Selection

	ZG1	ZG2	ZG3	ZG5	ZG6	ZG7	ZG8	ZG9	ZG10	ZG11
Max Volume at 1 cP [ltr]	10	50	250	850	1200	2000	5000	10000	20000	30000
Max Speed [rpm]	490	490	490	490	490	490	343	245	245	210

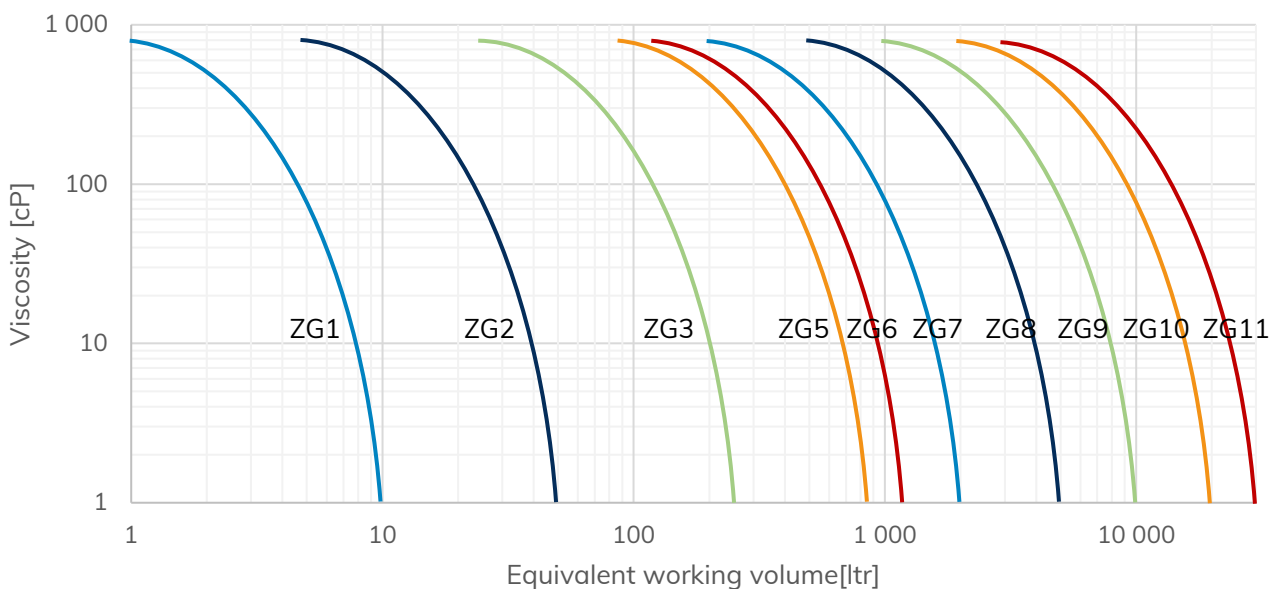

The information in this publication is subject to change without prior notice. The information in this document is believed to be complete and accurate at the time of publication. Metenova assumes no responsibility for any errors that may appear in this document. Customer is responsible for determining Metenova's product will perform suitable in the intended application.

mete  nova

A REPLIGEN COMPANY

Metenova AB
Norra Ågatan 32, SE-43135
Mölnådal, Sweden
Phone +46(0)31 3359500
www.metenova.com
info@metenova.com

Metenova America INC
P.O Box 398
Glen Gardner, NJ 08826
USA
Phone +1(908)537 4199
info@metenova.com

Mix Head

Male Post

Tank Plate

Drive Unit

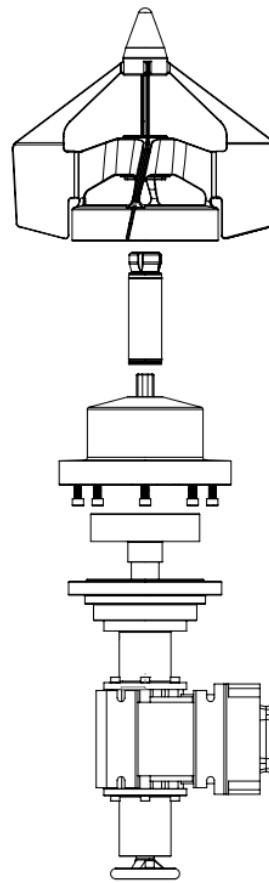
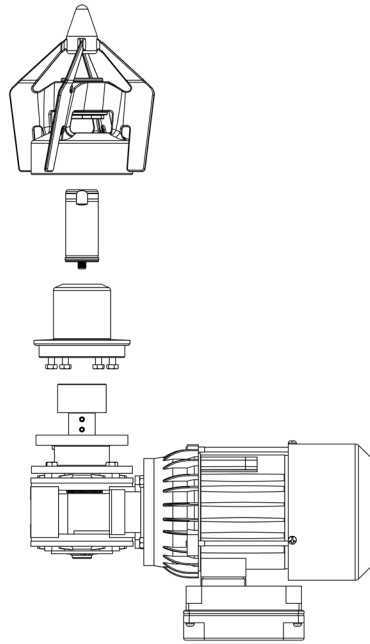

Mix Head

Male Post

Tank Plate

Drive Unit

General guide for components detail specification datasheet

(More variation options available for each subcomponent)

Mix Head	Male Post	Tank Plate	Drive Unit
DS-047 ZG Mix Head	DS-045 ZG Male Post	DS-048 ZG Tank Plate	DS-049 ZG Drive Unit AC

Net Weight (approximate)

Mixer Model	ZG1	ZG2	ZG3	ZG5	ZG6	ZG7	ZG8	ZG9	ZG10	ZG11
Weight kg (lb)	7 (15)	7 (15)	10 (22)	15 (33)	17 (37)	21 (46)	39 (86)	48 (106)	67 (148)	91 (201)

Additional Information

Operating Temperature	5°C - 150°C (41°F - 302°F)
Environment Temperature	0°C - 40°C (32°F - 104°F)
Operating Pressure	-1 – 7 barg (-14.7 – 103 psig)
Surface Roughness	Ra ≤ 0.38 µm (15 µin)
Surface Treatment	Electro polished. Non animal origin polishing compounds are used.
Product Contact Material	Stainless Steel ASME TP 316L acc. to SA-479 & EN 1.4435 acc. to EN 10272 bearing material SSiC and elastomers EPDM (USP VI , FDA compliant). (Other materials are available upon request)



A REPLIGEN COMPANY

Metenova AB
 Norra Ågatan 32, SE-43135
 Mölndal, Sweden
 Phone +46(0)31 3359500
 www.metenova.com
 info@metenova.com

Metenova America INC
 P.O Box 398
 Glen Gardner, NJ 08826
 USA
 Phone +1(908)537 4199
 info@metenova.com